

Schöck Isokorb® XT/T Typ KL-F

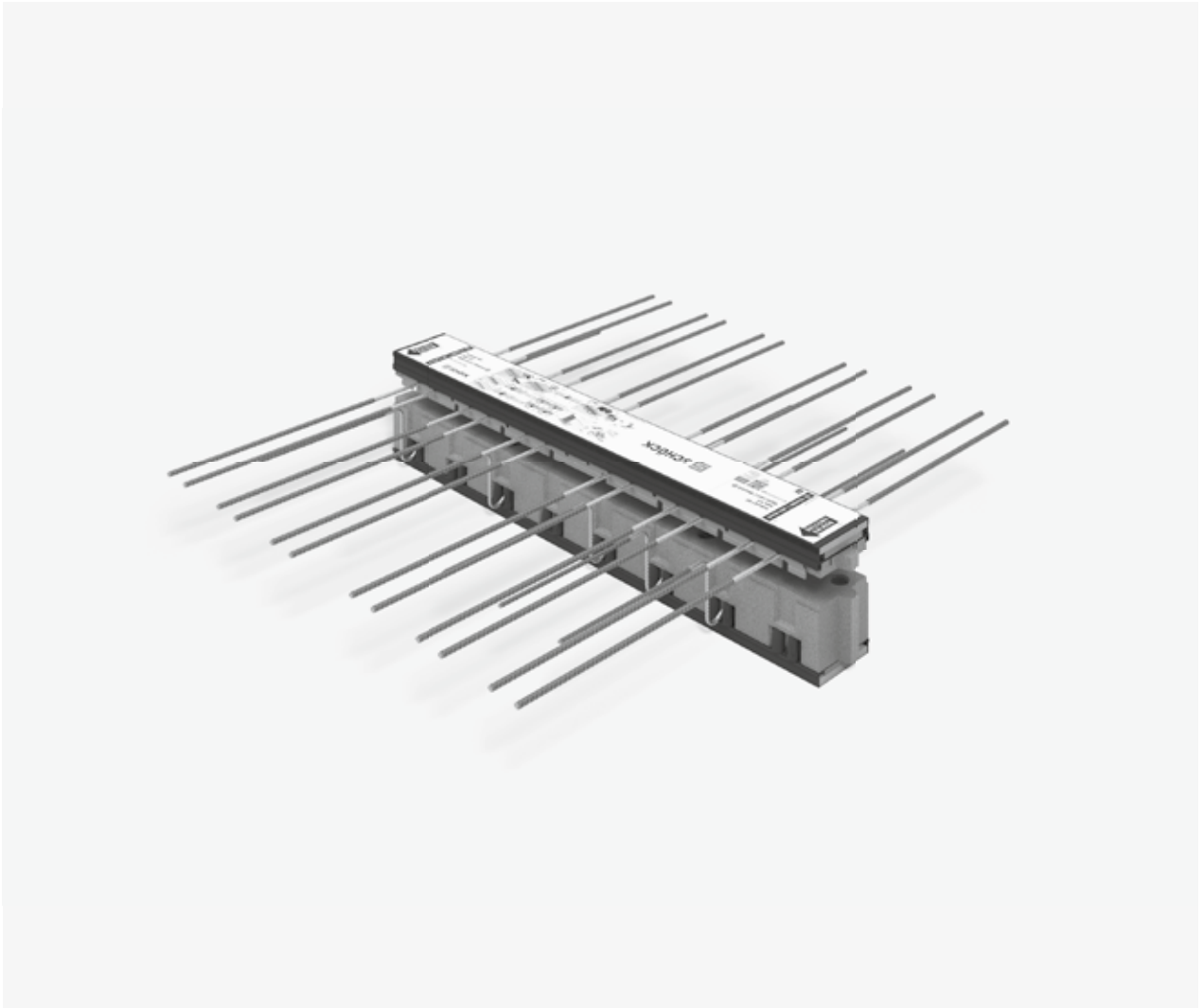

XT/T
Typ KL-F

Stahlbeton – Stahlbeton

Einbauanleitung – Fertigteilwerk

Typ KL-F

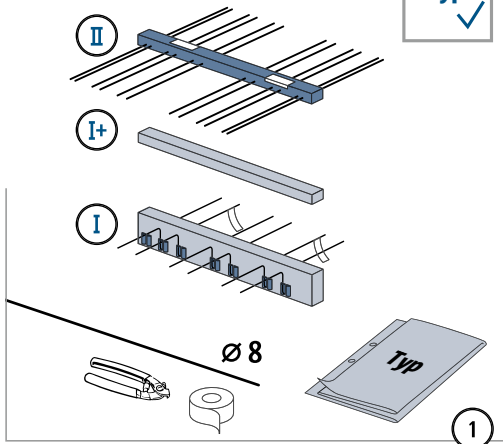

H	=	I	+	I+	+	II
160 mm	=	114	+	-	+	46
180 mm	=	114	+	20	+	46
190 mm	=	114	+	30	+	46
200 mm	=	114	+	40	+	46
⋮		⋮		⋮		⋮
250 mm	=	114	+	3 · 30	+	46

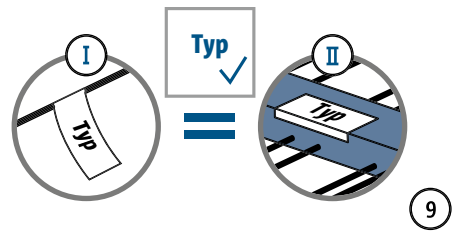
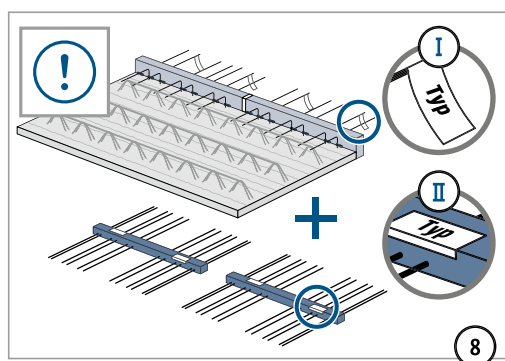
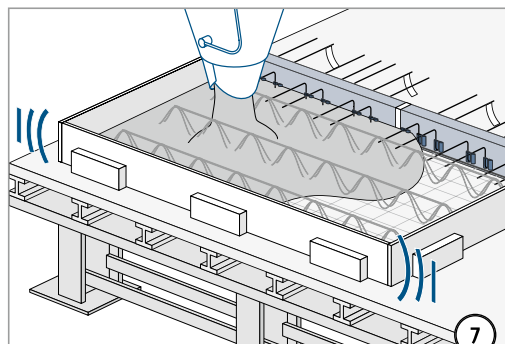
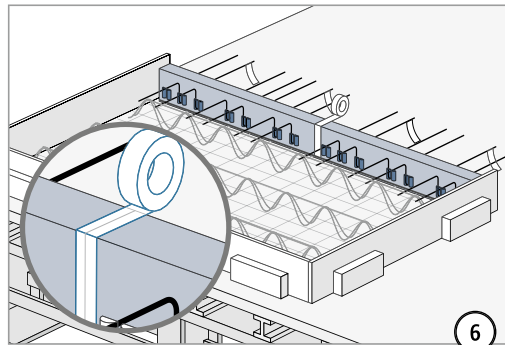
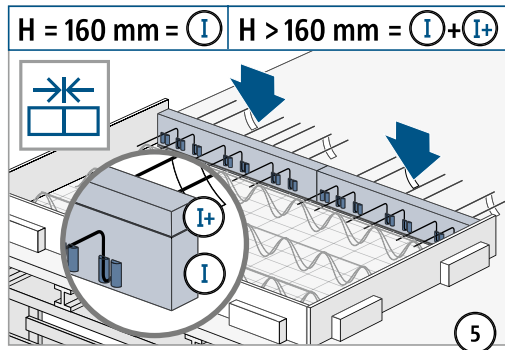
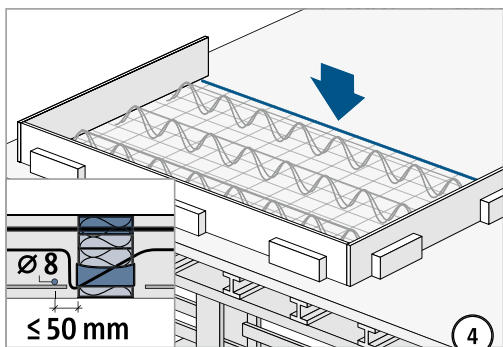
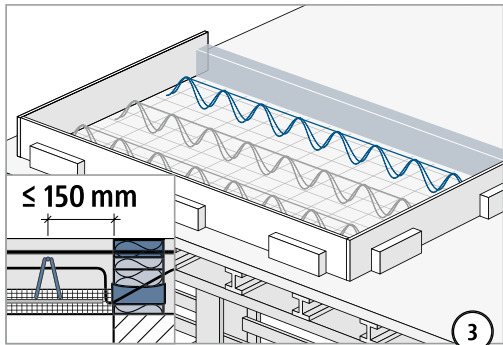

Auf gleiche Typenbezeichnung achten.

Einbauanleitung – Fertigteilwerk

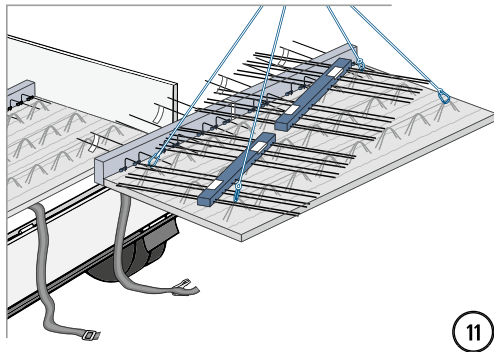
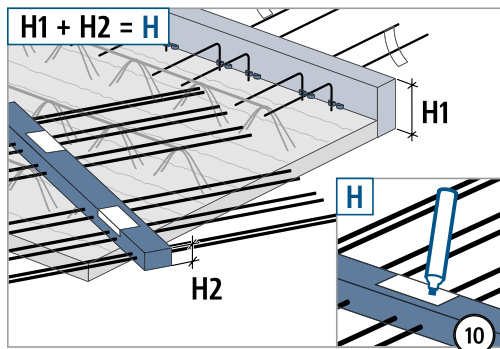
XT/T
Typ KL-F

Stahlbeton – Stahlbeton

Einbauanleitung – Fertigteil Baustelle

XT/T
Typ KL-F

Stahlbeton – Stahlbeton

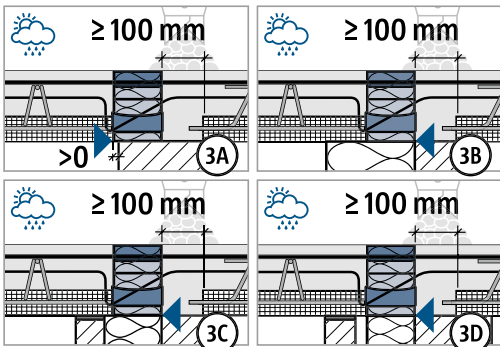
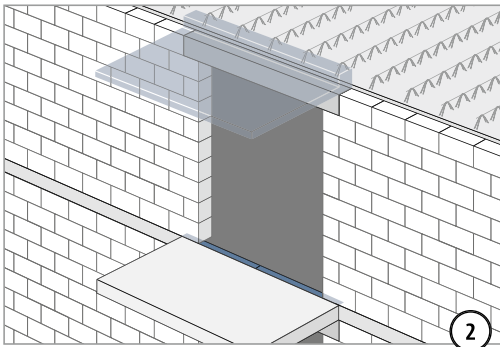
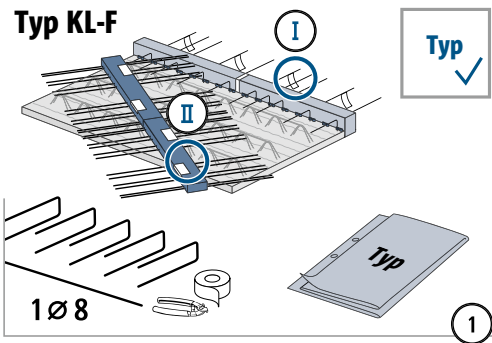

Druckfuge unbedingt mit Ortbeton verfüllen!
Fugenbreite ≥ 100 mm.

A		B
$h \leq 170$ mm	T Typ KL-F	$h > 170$ mm
$h \leq 180$ mm	XT Typ KL-F	$h > 180$ mm

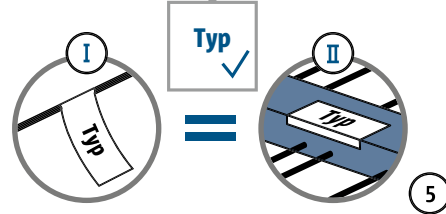
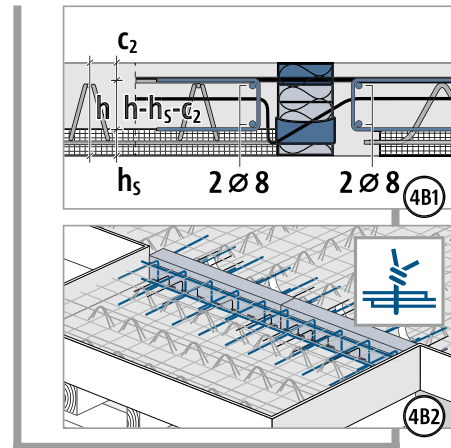
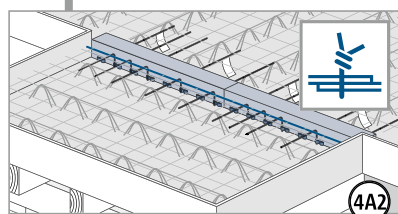
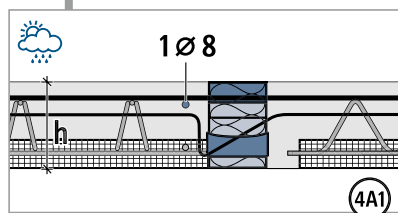

Auf gleiche Typenbezeichnung achten.

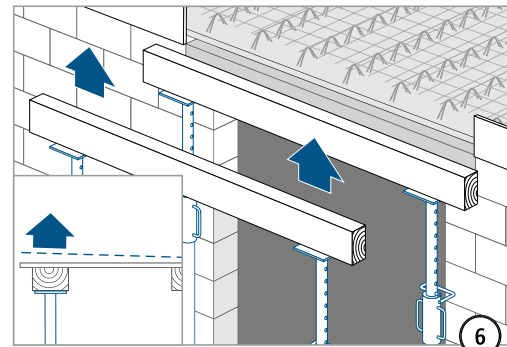

Schalung gemäß Werkplan überhöhen.

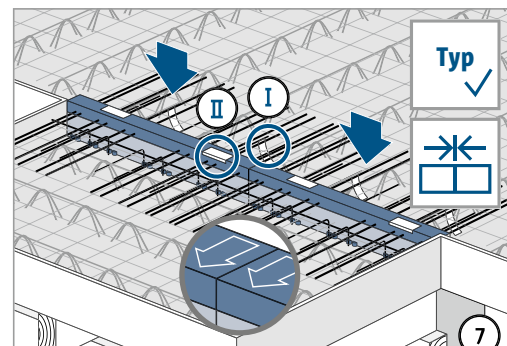

Oberteil II mit Zugstäben unbedingt einbauen!

Einbauanleitung – Fertigteil Baustelle

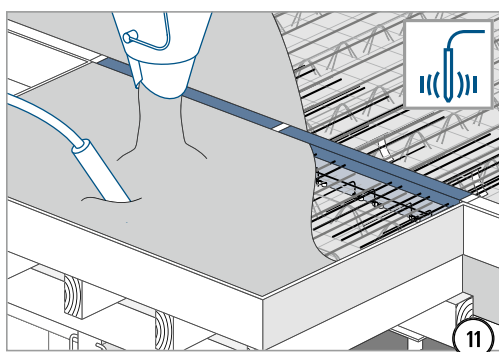
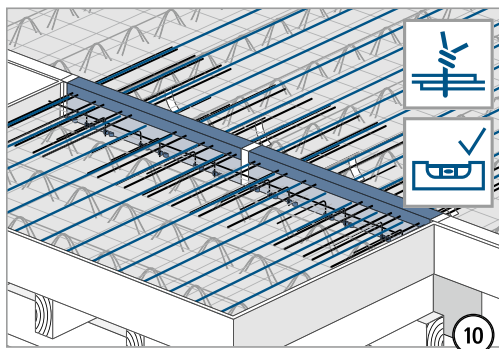
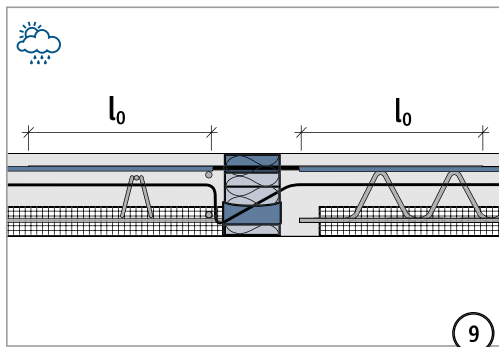
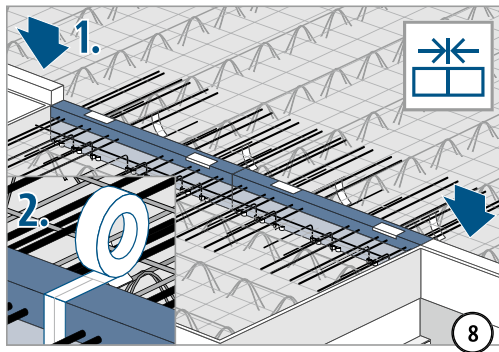

XT/T
Typ KL-F

Stahlbeton – Stahlbeton